

DATA SHEET

Company		Date	20/02/2023
Project		Item	
		Ref No.	

SNDS 300-700-710

Horizontal, double suction, single stage, axially split volute casing pump

Operating Point Data

Capacity	:	Power at Duty Point	:
Head	:	Frequency	: 50 Hz
Efficiency (%)	:	Voltage	: 400 V
Impeller Diameter	: 600 mm	Motor Power	: 710.00 kW
NPSHr	:	Nominal Speed	: 1492 rpm
Shut Off Head	: 137.9 m		

Liquid Data

Liquid	: Water	Density	: 998.30 kg/m ³
Temperature	: 20 °C	Viscosity	: 1.005 mm ² /s

Pump Data

Design	: Double suction, Single stage	Type of Coupling	: Standard
Installation	: Horizontal	Impeller Type	: Double Suction
Suction Flange	: EN 1092 PN 25-DN 400	Type of Bearing	: Grease Lubricated Bearing
Discharge Flange	: EN 1092 PN 25-DN 300	Type of Shaft Sealing	: Soft Packing
Direction Of Rotation	: Clockwise from the drive end		

Materials

Volute Casing	0.6025 / GG25 / EN-GJL-250 / ASTM A48 Class 40B
Impeller	0.6025 / GG25 / EN-GJL-250 / ASTM A48 Class 40B
Shaft	1.4021 / X20Cr13 / ASTM A276 Type 420
Bearing Housing	0.6025 / GG25 / EN-GJL-250 / ASTM A48 Class 40B
Casing Wear Ring	2.1050.01 / G-CuSn10 / ASTM B427 C90700
Shaft Protecting Sleeve	1.4021 / X20Cr13 / ASTM A276 Type 420

Operating Point Data

Company		Date	20/02/2023
Project		Item	
		Ref No.	

SNDS 300-700-710

Horizontal, double suction, single stage, axially split volute casing pump

Capacity:		NPSHr:	
Head:		Motor Power:	710.00 kW
Efficiency (%):		Nominal Speed:	1492 rpm
Power at Duty Point:		Frequency:	50 Hz
Viscosity:	1.005 mm ² /s	Density:	998.30 kg/m ³

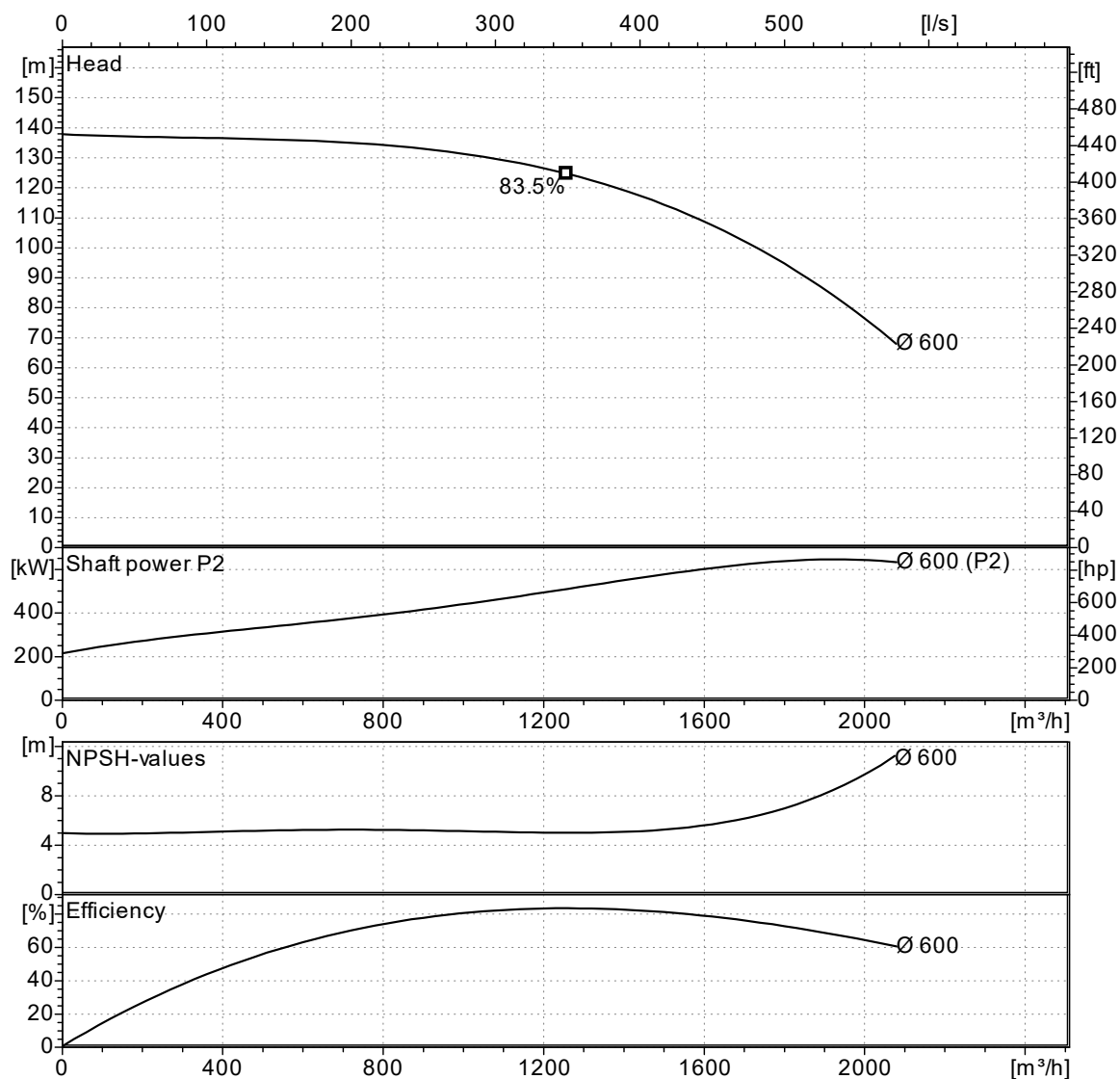

Curves compatible with ISO 9906:2012 Gr 3B

NPSHa > NPSHr + 1m

Note : The motor power is not sufficient for dotted area.

Company		Date	20/02/2023
Project		Item	
		Ref No.	

SNDS 300-700-710

Horizontal, double suction, single stage, axially split volute casing pump

Pump Dimensions

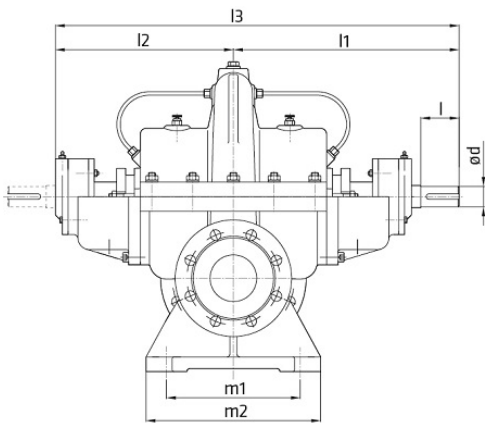

Name	Value
a1	750
a2	800
d	100
DNb	300
DNe	400
h1	710
h2	350
h3	470
l	180
l1	865
l2	675
l3	1540
m1	420
m2	520
n1	720
n2	800
s	26
W	1650 kg

Note : l1 and l2 replaced each other since pump shaft rotates counter-clockw ise.

Flange Dimensions



Suction Flange	Discharge Flange
AB = 400	AB = 300
Df = 620	Df = 485
k = 550	k = 430
n = 16	n = 16
s = 37	s = 31

" n " number of holes

Company		Date	20/02/2023
Project		Item	
		Ref No.	

SNDS 300-700-710

Horizontal, double suction, single stage, axially split volute casing pump

Motor Data

Efficiency Level :
 Motor type : Three-Phase Asynchronous Motor
 Motor Power : 710.0 kW
 Rated Speed : 1450 rpm
 Voltage : 400 V
 Rated Current : 0.00 A
 Frequency : 50 Hz
 Motor Phase : 3
 Service Factor : 1.15
 Insulation Class : F
 Degree of Protection : IP 55
 Efficiency : - %
 Power factor : 0.00